

Bureau of Land Management site to find the first transfer of land from government to individuals and legal description.

<https://glorerecords.blm.gov/>

Select State and County

Enter Surname to search

The screenshot shows the 'U.S. DEPARTMENT OF THE INTERIOR BUREAU OF LAND MANAGEMENT' website. The page title is 'PRIVATE CLAIMS General Land Office Records'. The navigation bar includes 'Search Documents', 'Reference Center', 'Support', and 'Shopping Cart'. The main content area is titled 'Search Documents' and has three tabs: 'Search Documents By Type', 'Search Documents By Location', and 'Search Documents By Identifier'. The 'Search Documents By Type' tab is active, showing a search form for 'Patents'. The form includes sections for 'Location' (State: ALABAMA, County: Any County), 'Names' (Last Name, First Name, Middle Name, search checkboxes), 'Land Description' (Township, Range, Meridian, Section #), and 'Miscellaneous' (Land Office, Issue Date, Document #, Indian Allot #, Survey #, Authority, Militia, Tribe, Geo. Name/Mining Claim). A 'Search Patents' button is at the bottom. A note states: 'Note: This site does not cover every state, but we do have resource links for most states.' The footer contains links for USA.GOV, No Fear Act, DOJ, Disclaimer, About BLM, Notices, Get Adobe Reader, Privacy Policy, FOIA, Kids Policy, Contact Us, Accessibility, Site Map, and Home.

# Use Earth Point to place section onto Google Earth

## Earth Point

<https://www.earthpoint.us/TownshipsSearchByDescription.aspx>

Enter State, Township and Range, and Section # of Land

Click on “Fly to on Google Earth”

The screenshot shows the Earth Point website interface. On the left is a navigation menu with categories like 'Worldwide Utilities', 'USA Utilities', and 'Township & Range'. The 'Search By Description' option is highlighted. The main content area is titled 'Township and Range - Search By Description.' and includes a search form with dropdown menus for State, Principal Meridian, Township, Range, and Section. A 'Fly To On Google Earth' button is visible. A light blue message box states that a user account is not needed. A red note at the bottom explains that clicking the 'Fly To' button will return the user to the BLM or National Atlas 'View on Google Earth' button, also noting that no account is needed.

**Earth Point** Tools for Google Earth [Sign In / Buy Subscription](#) [Contact](#)

**Township and Range - Search By Description.**

A user account is **not** needed for the features on this web page.

Enter Township and Range. Optionally enter Section. Google Earth flies you there using BLM data. Hint: pause for a moment after choosing each of the criteria. This allows the data to be loaded into the drop-down boxes.

State: (any) ▾  
Principal Meridian: First ▾  
Township: 001 N ▾  
Range: 001 E ▾  
Section: ▾ (optional)

Free. User account is not needed.

If you want to see the surrounding townships, then once you have clicked the "Fly To" button, come back and click the BLM or National Atlas "View on Google Earth" button. Free. User account is not needed.

# Edwin Dozier Eubank - Section 22

U.S. DEPARTMENT OF THE INTERIOR *PRIVATE CLAIMS*  
**BUREAU OF LAND MANAGEMENT** General Land Office Records

Search Documents Reference Center Support Shopping Cart

Search Documents Results List

Printer Friendly

Image	Accession	Names	Date	Doc #	State	Meridian	Twp - Rng	Aliquots	Sec. #	County
	<a href="#">NE0860 .120</a>	EUBANK, CYRUS R	8/12/1891	5511	NE	6th PM	018N - 018W	NW¼	13	Custer
	<a href="#">NE1010 .430</a>	EUBANK, CYRUS R	9/7/1887	6470	NE	6th PM	018N - 018W	NE¼	14	Custer
	<a href="#">NE0980 .231</a>	EUBANK, EDWIN D	9/10/1883	4881	NE	6th PM	018N - 017W	S½SE¼	22	Custer
							018N - 017W	NW¼SE¼	22	Custer
							018N - 017W	NE¼SW¼	22	Custer

Rough sketch shape of land from legal descriptions helps

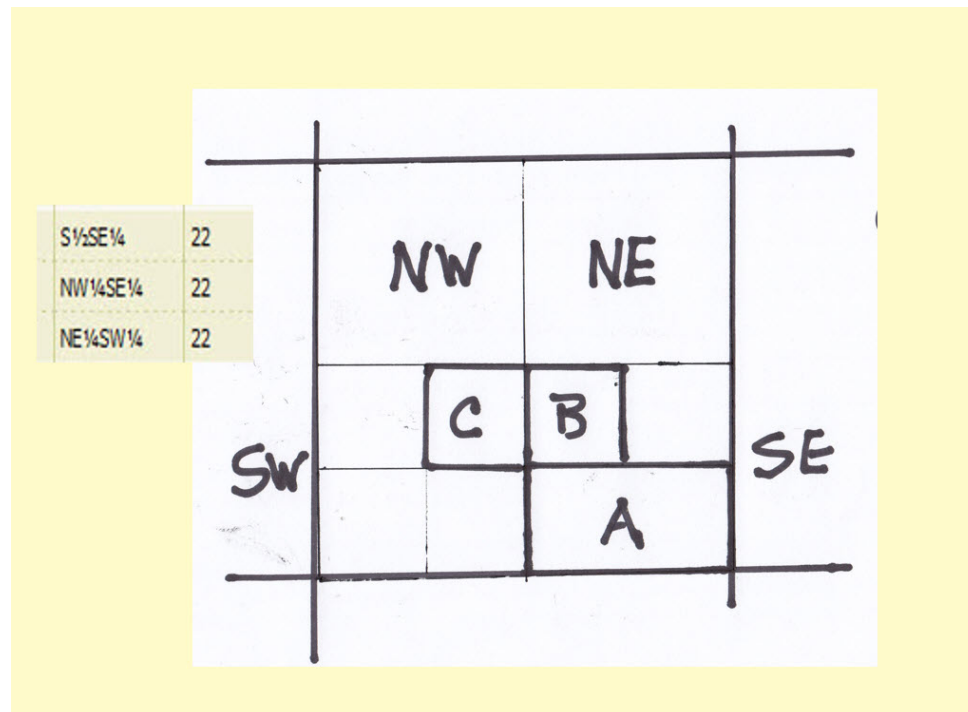

Draw outline on Google Earth inside Section using Path tool.  
Choose line width and color

